

NOTES: UNLESS OTHERWISE SPECIFIED

1. SEE DRAWING NO. CB-00315 AND PROCEDURE P-1000 FOR ASSEMBLY AND TEST INSTRUCTION. PROCEDURES AND ASSEMBLY DRAWINGS ARE FOR INTERNAL USE ONLY.
2. ALL TESTING ARE IAW BATTERY COUNCIL INTERNATIONAL STANDARDS.
3. ALL DIMENSIONS ARE IN INCHES [MM].

REVISIONS			
REV	DESCRIPTION	DATE	APPROVED

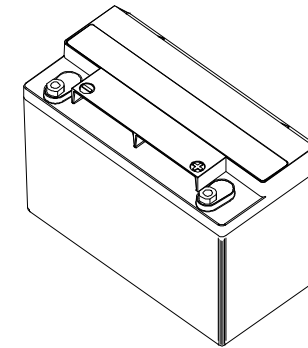
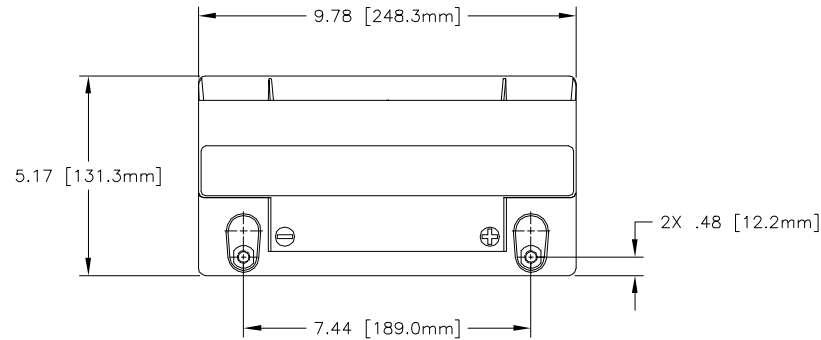

REFERENCE VIEW

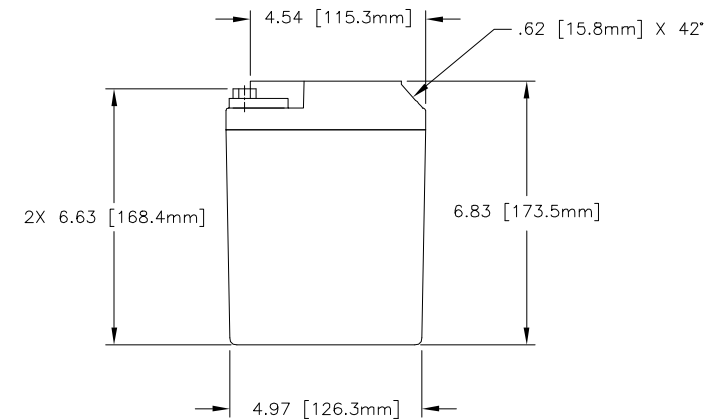
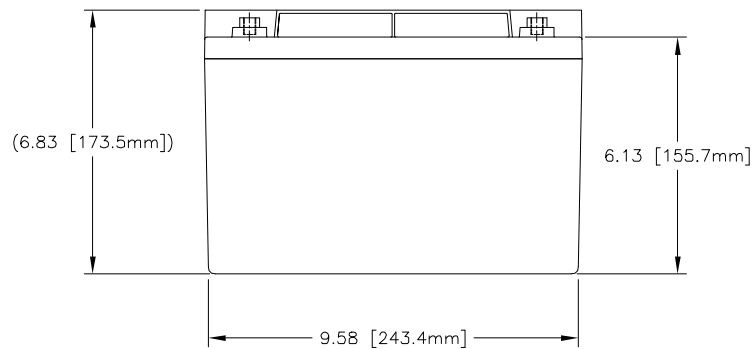

PART NUMBER	GPL-1400
MAXIMUM WEIGHT	32 LBS [14.5 KG]
RATED CAPACITY, C ₁	33 AH
CRANKING Amps @ 68° F	850
CRANKING Amps @ 32° F	700
CRANKING Amps @ 0° F	550
RESERVE CAPACITY	90 MIN

ENVELOPE DRAWING

QTY	REQD	CAGE CODE	PART OR IDENTIFYING NO.	NOMENCLATURE OR DESCRIPTION	MATERIAL SPECIFICATION	ITEM NO.
PARTS LIST						
UNLESS OTHERWISE SPECIFIED DIMENSIONS ARE IN INCHES TOLERANCES ARE:				CONCORDE BATTERY CORPORATION		
FRACTIONS .XX ± .06				2009 SAN BERNARDINO RD, W. COVINA, CA 91790		
DECIMALS .XXX ± .080				BATTERY, VRSLA, 12 VOLT, GPL-1400		
ANGLES				DWG NO. GPL-1400		
TREATMENT NONE				APPROVALS	DATE	REV
FINISH NONE				DRAWN HRF	7/12/00	
SIMILAR TO				CHECKED SV	7/13/00	
ACT WT				APPROVED JBT	7/21/00	
CALC WT				ISSUED DR	8/7/00	
SCALE 1=2.5		SHEET 1 OF 1				